

Social Space Study Ötlingen - Lindorf

01

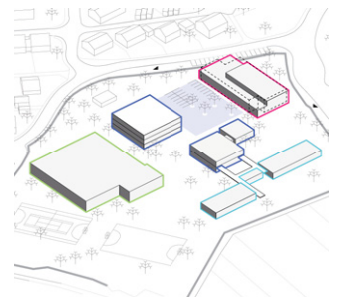
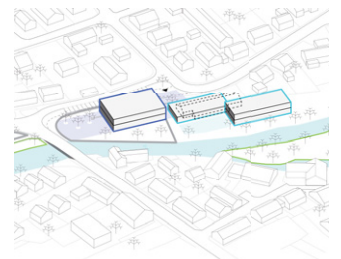
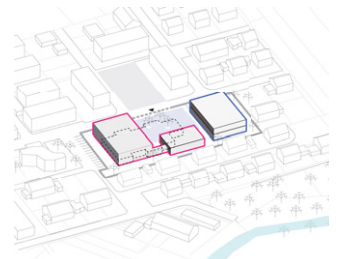
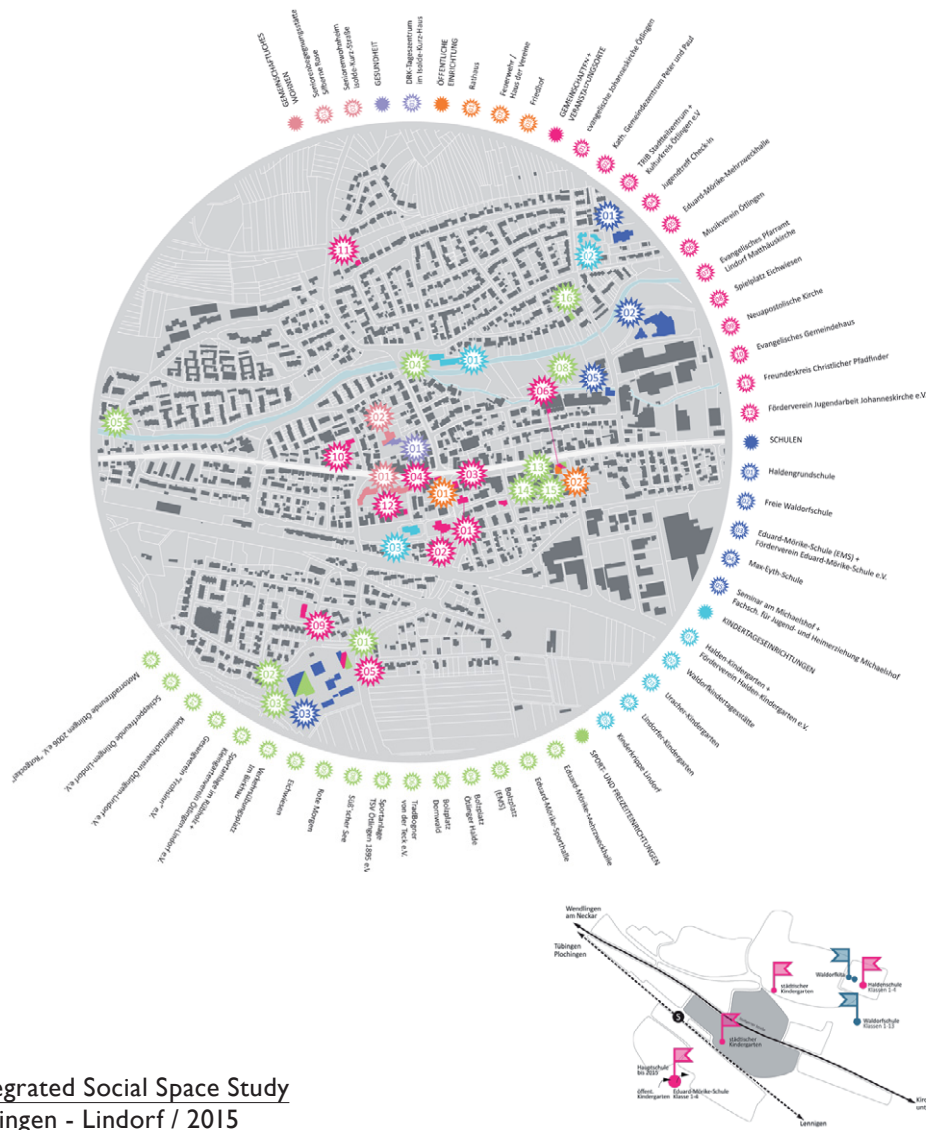

Integrated Social Space Study
Ötlingen - Lindorf / 2015

Project	ISO
Status	Social Space Study, completed
Client	City of Kirchheim u.T.
in Coop. with	Compare Consulting

The integrated social space study 'School in the midst of the local community of Ötlingen and Lindorf' comprised the conception, organization, execution and evaluation of miscellaneous analytical procedures and methods of participation in order to cope with different thematic key aspects in this outer quarter of Kirchheim.

Special attention was paid to the question of the future second location of the Eduard-Mörke Primary School, the current Halden School. Further emphasis was laid on the present and future situation of (sports) halls in Ötlingen and the social infrastructure. The social space study was conducted in projective manner in three workshops

broaching various related issues with the different groups of actors such as teachers, parents, associations and townspeople. As conclusion different scenarios for a school in the midst of the local community and for possible halls were developed and prioritized.

- 01 Public and educational institutions in Ötlingen
- 02 Schools and kindergartens in Ötlingen
- 03 Possible sites for a 2nd school location