

House M



02



01



03

House M – Laupheim / 2010

Project	EFM
Client	Private
Year	2008 – 2010
Status	Completed
Gross Building Area	362 m ²
Gross Building Vol.	1.069 m ³

The residential building from the late 50s is kept in its position on the plot. It is stripped down to the walls of the ground floor and built up again.

The modern way of living in the ground floor is complemented by individual rooms on the upper floor. Hence the building can be inhabited by different users throughout the time.

The removed core of the ground floor is structured only through built-in furniture, thus it gains an open character. The rooms extend outside through gazebo-like annexes that connect the interior to the exterior. A clear void joins the upper and lower floors. A beech hedge and the new carport enclose the two private gardens.



05



04

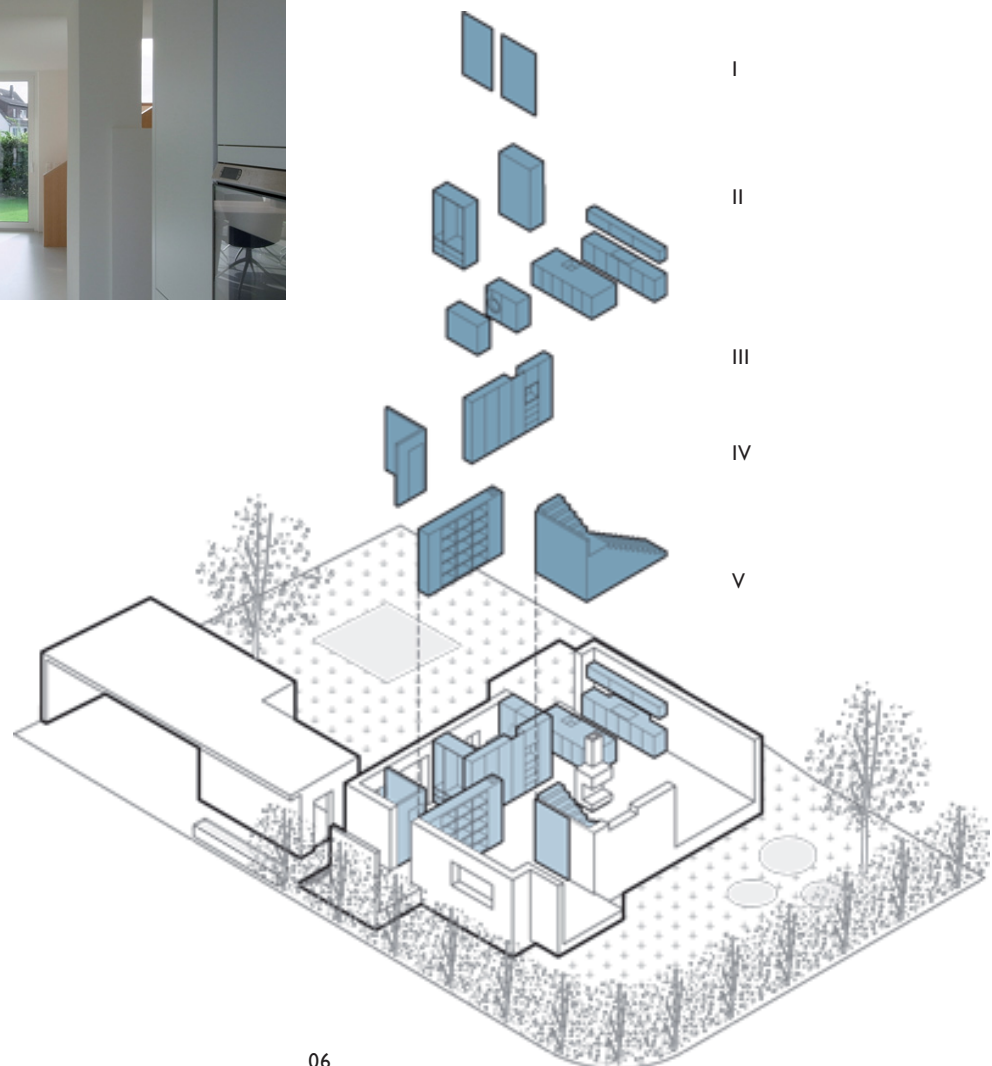

06

- ←
- 01 Street view
 - 02 Inside-outside relation
 - 03 Sliding doors open and closed
 - 04 Kitchen - dining - garden
 - 05 Variable open space
 - 06 Structuring of the open space through built-in furniture
 - I Sliding doors
 - II Storage
 - III Laundry and kitchen
 - IV Toilet and wardrobe
 - V Living room shelves and stair